

# SW40-H Quick Guide Setup

## SW40-H Handheld Transmitter

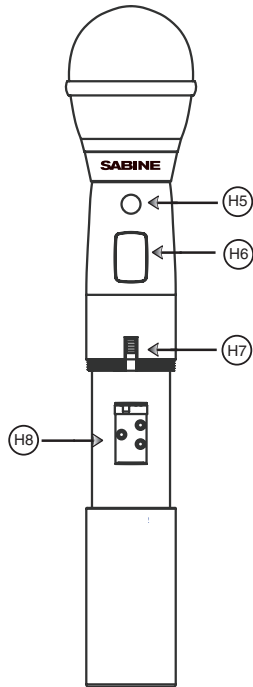

### Controls

- (H1) Select Button
- (H2) Up Button
- (H3) Down Button
- (H4) Programmable Control of External Switch
- (H5) Infrared Port
- (H6) Transmitter LCD Screen
- (H7) External Switch
- (H8) Transmitter controls and battery compartments

- (A) Group Number
- (B) Channel Number
- (C) Antenna Indicator - Low output
- (D) Antenna Indicator - High output
- (E) Battery life Indicator

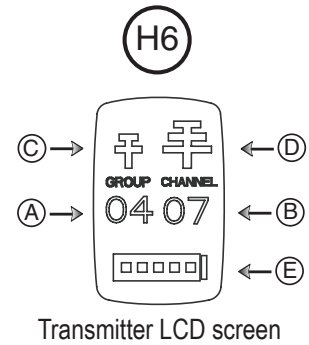

Transmitter LCD screen

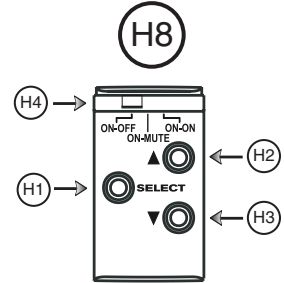

Transmitter Controls

## Setting up your Wireless Microphone System

1. Plug the power supply into the receiver and the wall socket.
2. (SW40-RH) Push the MENU button until the words Auto Select appear in the LCD. (SW40-RF) Push the MENU button until the word scan appears in the LCD.
3. Push the SET button. The SW40-RH or SW-40-RF will set itself to a clear channel and display the channel on the receiver LCD.
4. Turn on a transmitter (leave the other transmitters turned off). Aim the transmitter's IR sensor about 8 inches from the receiver's IR scanner and press the receiver's S.O. (SYNC) button for several seconds while the receiver programs the transmitter. When the group and channel numbers on the transmitter matches the receiver, the system is ready to operate. When you are standing close, the RF LED ladder on the SW40-RH should be fully lit or, on the SW40-RF, the RF LED bar will be lit.

**Expose the transmitter IR port to the receiver (within 8 inches), press S.O. (SYNC)**

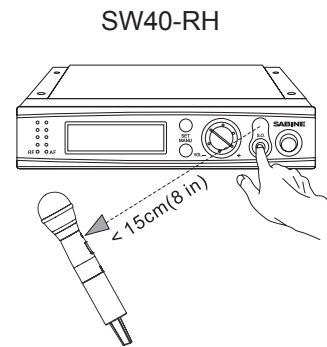
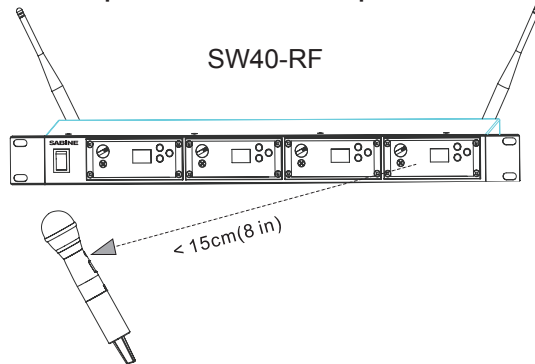

5. Speak, sing or play into the transmitter to adjust the volume control so that the A.F. LEDs generally light under normal performance conditions. The volume should be adjusted so that the top A.F. LED only lights momentarily with the loudest inputs. You will hear a harsh clipping sound if the top LED stays lit under normal levels.
6. Adjusting the squelch. The squelch controls the maximum distance between the transmitter and receiver. It is set to maximum range at the factory and should be kept there in most cases.

### For Multiple Systems

- Repeat steps 1 – 6 if you wish to add more systems.

### IMPORTANT:

- Make sure to keep the transmitters that have been set up turned on so that new receivers will know those channel are busy.
- Be sure that only one transmitter's IR port is exposed when setting up a system.

**SABINE**<sup>®</sup>  
the sound of innovation

# SW40-H Quick Guide Setup

## Opening the Handheld Transmitter Access Compartment:

1. Unscrew lower portion of the case. Continue turning as you pull down.

## Closing the Handheld Transmitter Access Compartment:

2. Begin by turning the lower portion of the case as you push up. When threads meet screw on until snug.

NOTE: Do NOT attempt to unscrew the mic capsule from the body.

This will void your warranty!

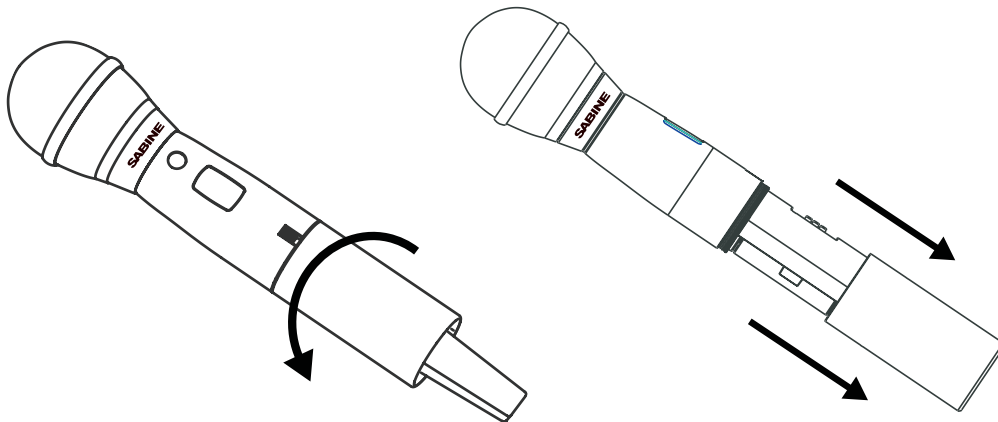

## Acceptable Batteries for use with SW40-H Handheld Transmitters

### 2 "AA" size (14.5x50.5mm, 単3電池2本使用)

- NiMH Rechargeable
- Alkaline: NEDA 14A - ANSI 14A - IEC LR14
- Heavy Duty batteries (NOT recommended)

## Battery Caution



DO NOT BURN OR PUNCTURE BATTERY.  
DOING SO COULD CAUSE INJURY.



DO NOT SHORT CIRCUIT.  
RECYCLE OR DISPOSE OF PROPERLY.

**SABINE**<sup>®</sup>  
the sound of innovation

13301 NW US Highway 441  
Alachua, FL 32615-8544 USA

+USA (386) 418-2000

+USA (386) 418-2001 fax

Sabine@Sabine.com • www.sabine.com

Please register your product at [www.sabine.com](http://www.sabine.com)